

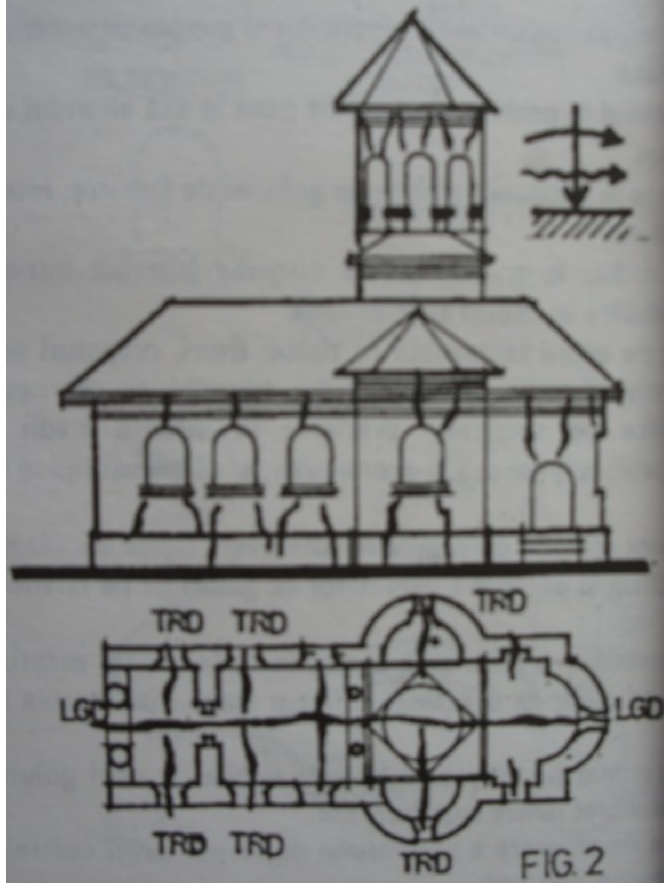

# CONSTRUCȚII UNU IAȘI

etii instalatii tamplarie constructii instalatii tamplarie  
etii instalatii tamplarie constructii instalatii tamplarie

LONGITUDINAL / TRANSVERSE  
FRAGMENTATION OF THE CHURCH BODY  
IN DISTINCT BLOCKS



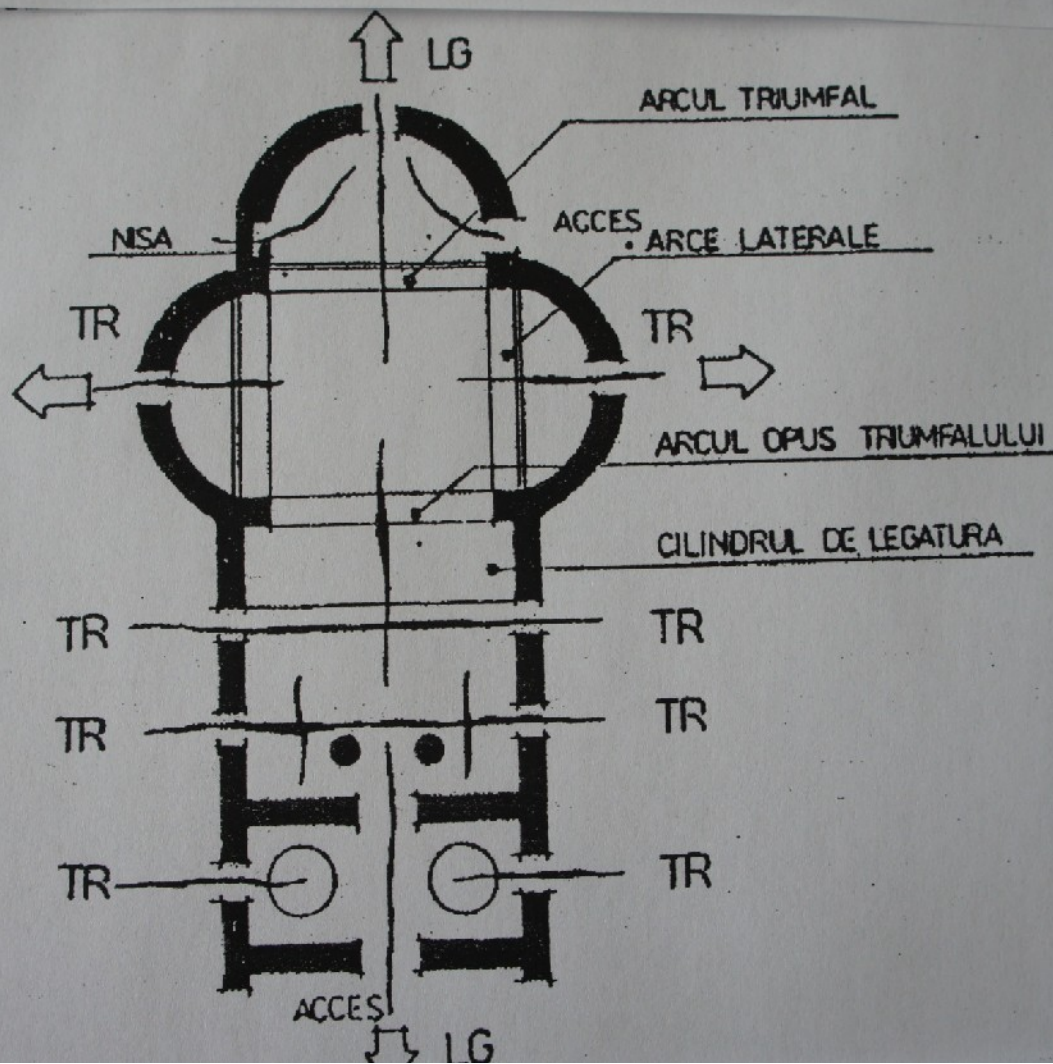

APSES

THE APSES WINDOW

fig 3b

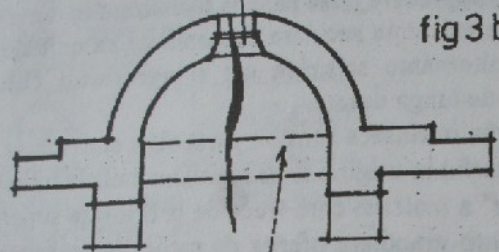

THE APSE ARCH

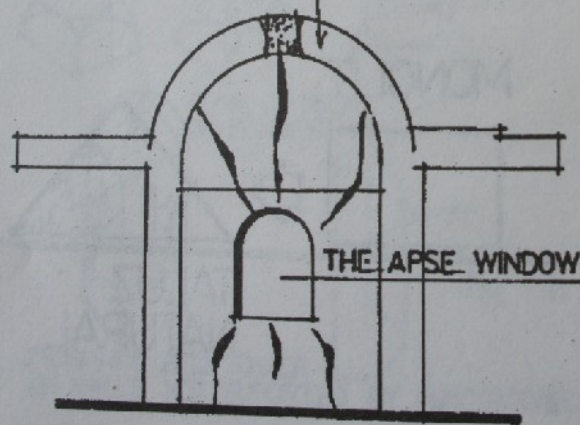

THE APSE WINDOW

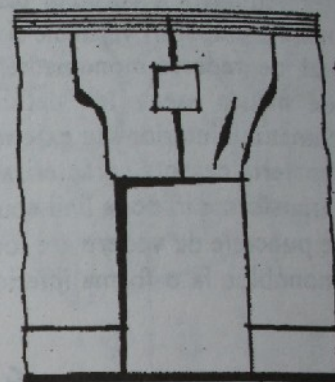

fig 3c

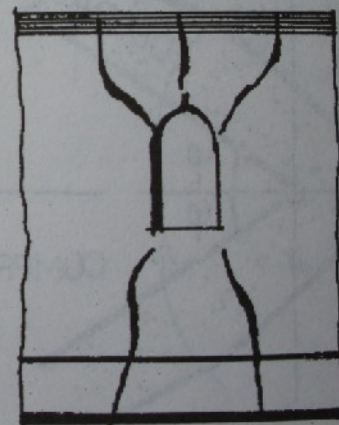

fig 3d

#### A. Materiale care intra in compozitii perfect aderente si compatibile

# Mortar-betonul grosier (MBG)

# Mortar-betonul fin (MBF)

# Otelul ductil (OD)

# Compozitii:

(MBG + OD) = MB grosier armat = (MBA)

(MBF + OD) = MB fin armat = (MFA)

# Lapte de ciment pentru injectii in masive, departe de paramentul pictat (daca este cazul).

# Lapte de var injectat pentru completarea enclavelor ascunse in masive (Cozia)

# Caseinatul de calciu in pasta si mortar pentru tratamente in preajma paramentului pictat.

MORTAR-BETON GROSIER (MBG)	MORTAR-BETON FIN (MBF)	CASEINAT DE CALCIU (CC)
1 parte CIMENT 2,5 parti NISIP GRAUNTOS 1,5 parti MARGARITAR 0,5 parti VAR DE FLUIDIFICARE APA in exces pentru a asigura punerea in opera prin simpla turnare	1 parte CIMENT 2,5 parti NISIP GRAUNTOS + MARGARITAR FIN (3-5)mm 0,5 parti VAR DE FLUIDIFICARE APA suficienta	<u>PASTA DE CC</u> 1 parte VAR VECHI 2 parti BRANZA DE VACA DEGRESATA <u>MORTAR DE CC</u> 2 parti PASTA 3 parti (sau 2) NISIP

#### B. Materiale folosite in zone unde criteriile severe de compatibilitate nu se pun:

# Betonul simplu

# Betonul armat obisnuit

# Otelul ductil in profile sau in bare rotunde

# Betonul armat cu armatura rigida (BAR)

# CARCASA SPATIALA ANTISEISMICA

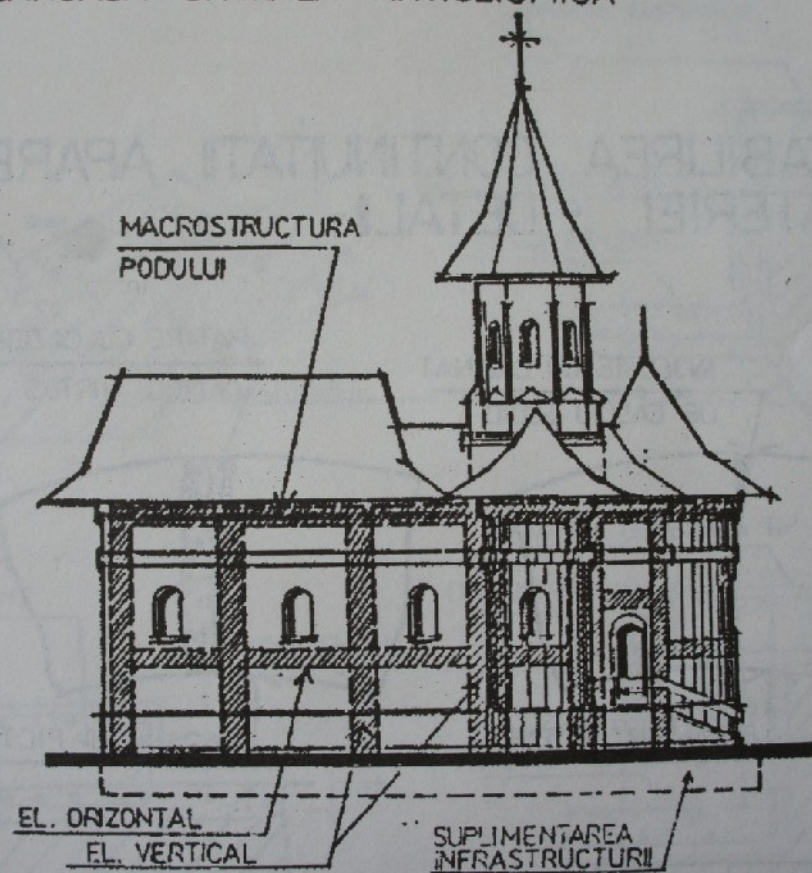

# SISTEMUL ELEMENTELOR VERTICALE LAMELARE

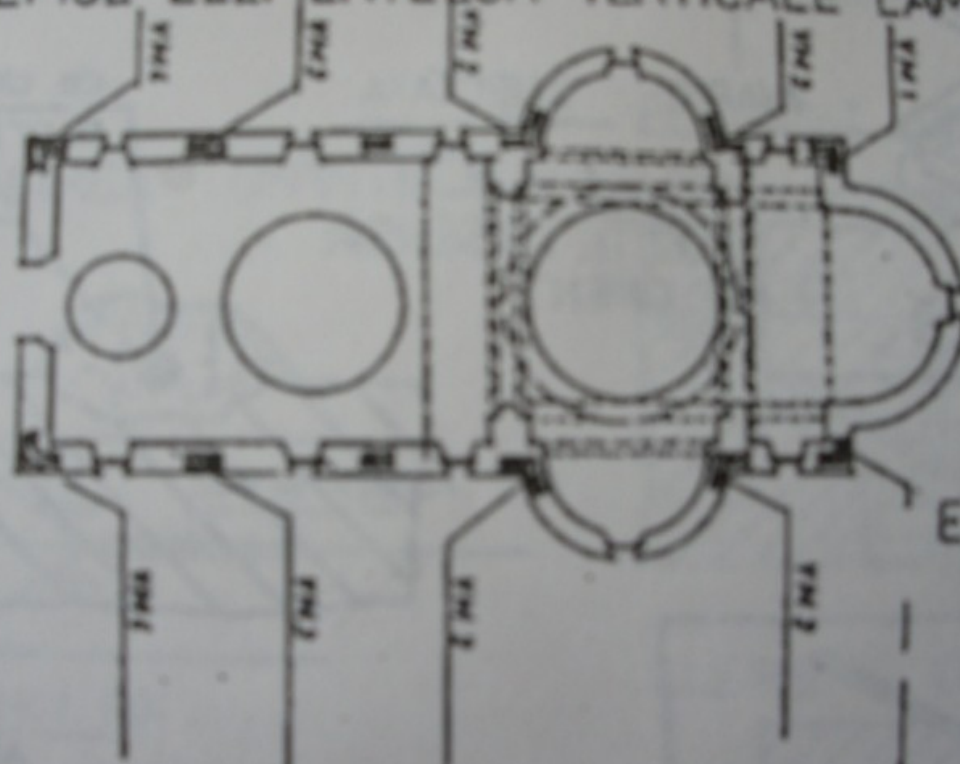

EVL tip 1

# MACROSTRUCTURA PODULUI

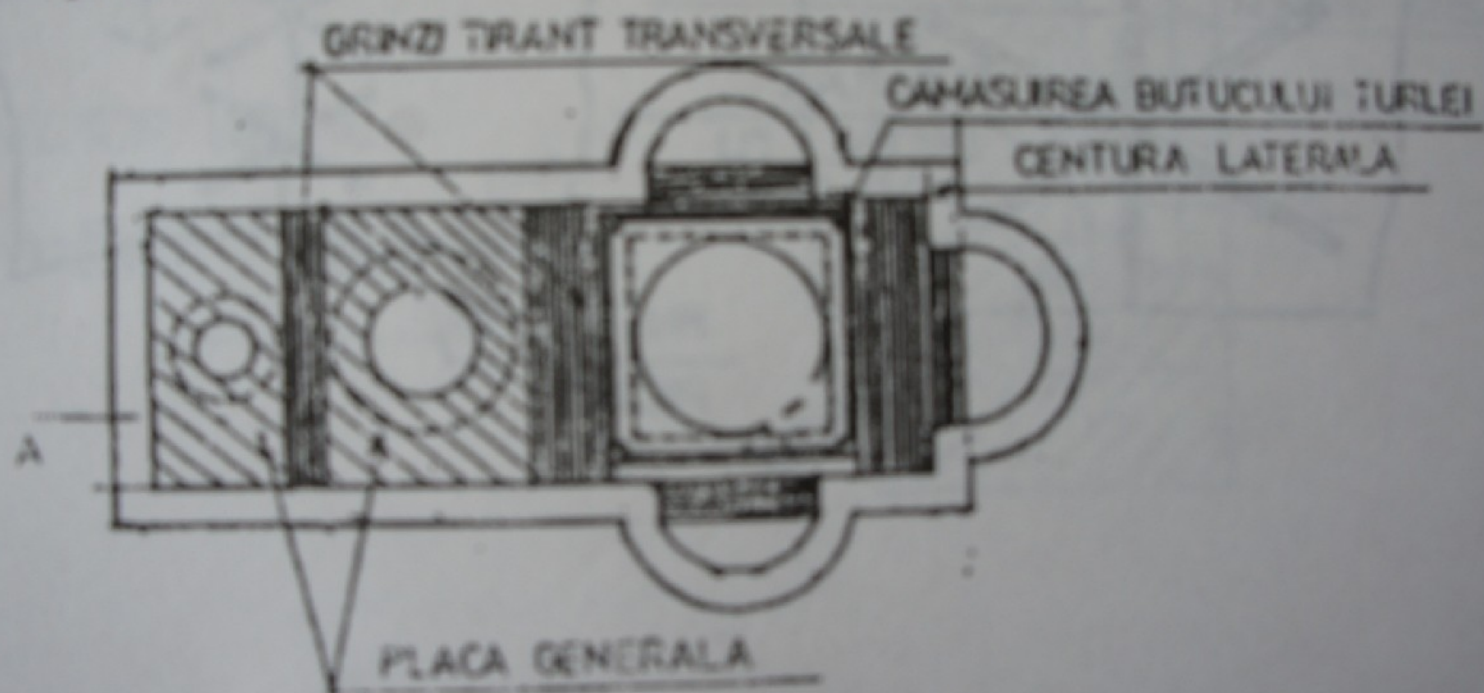

ELEMENT VERTICAL

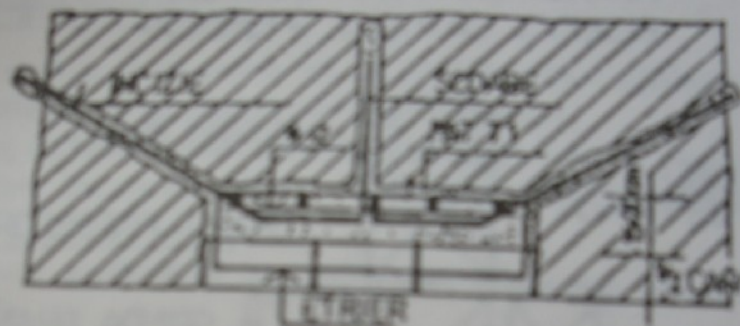

ELEMENT ORIZZONTAL



SUPLIMENTAREA SISTEMELOR  
DE FUNDARE

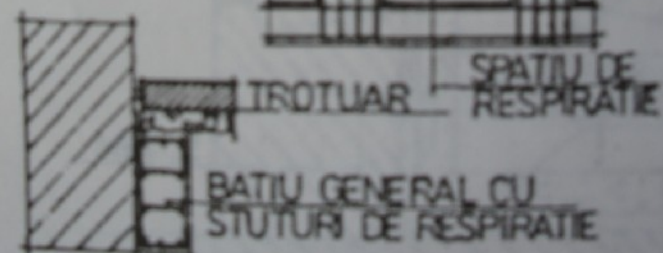
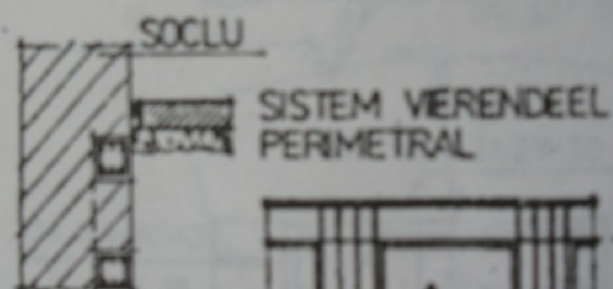

## CONTRAFORTI SUBTERANI

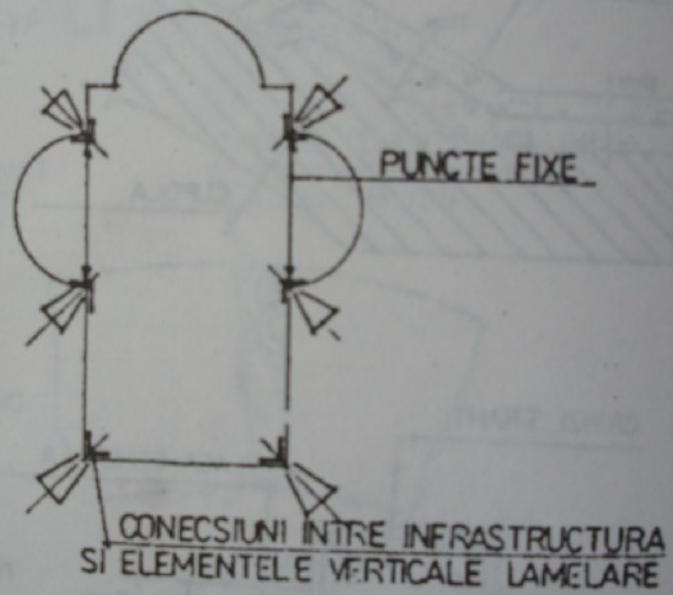

INTERVENȚII INTERIOARE ÎN CAZUL  
INFRASTRUCTURILOR PE TERENURI  
MACROPORICE SAU ALUNECĂTOARE

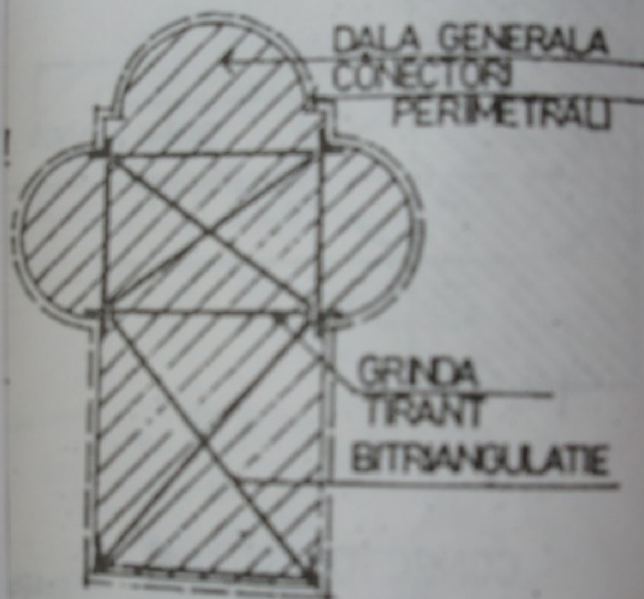

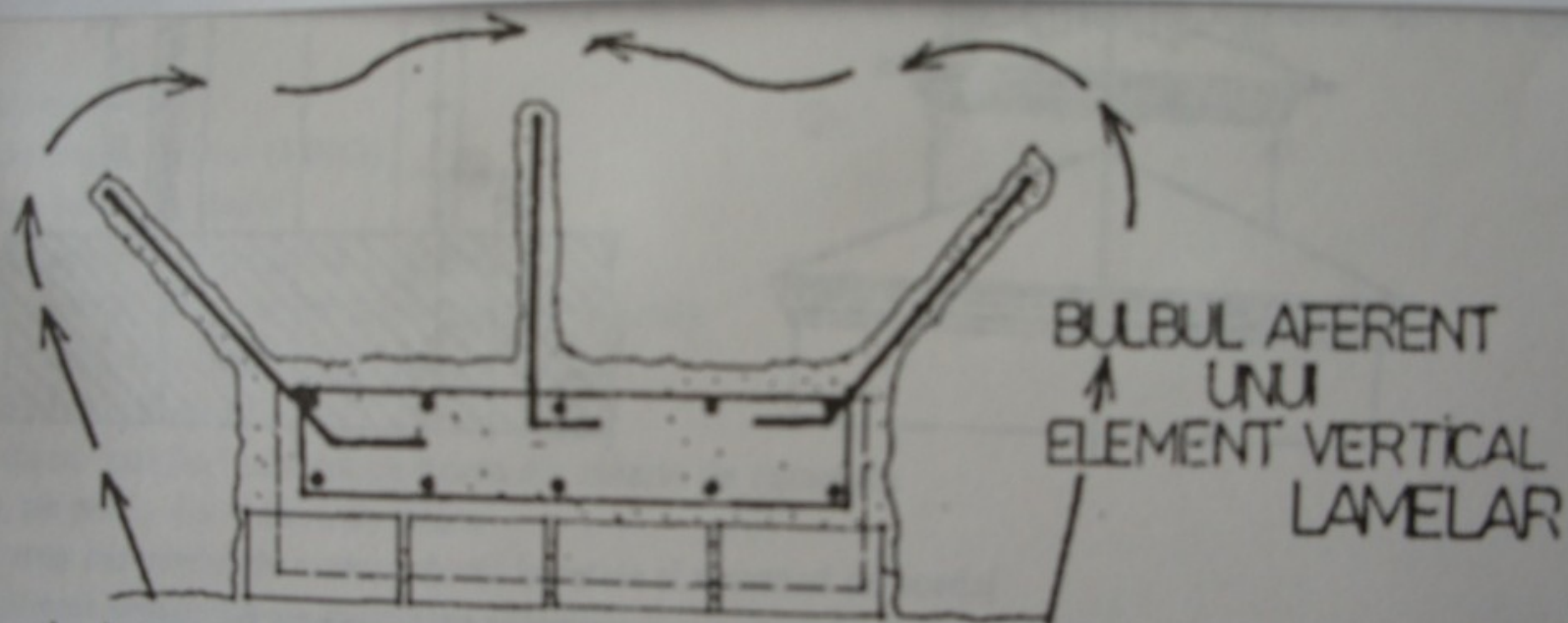

AVARIE TIPICA A TURLEI  
URMARE A RASTURNARI  
SI FORFECARI SEISMICE























PLAN STRUCTUR À RIGID À POD

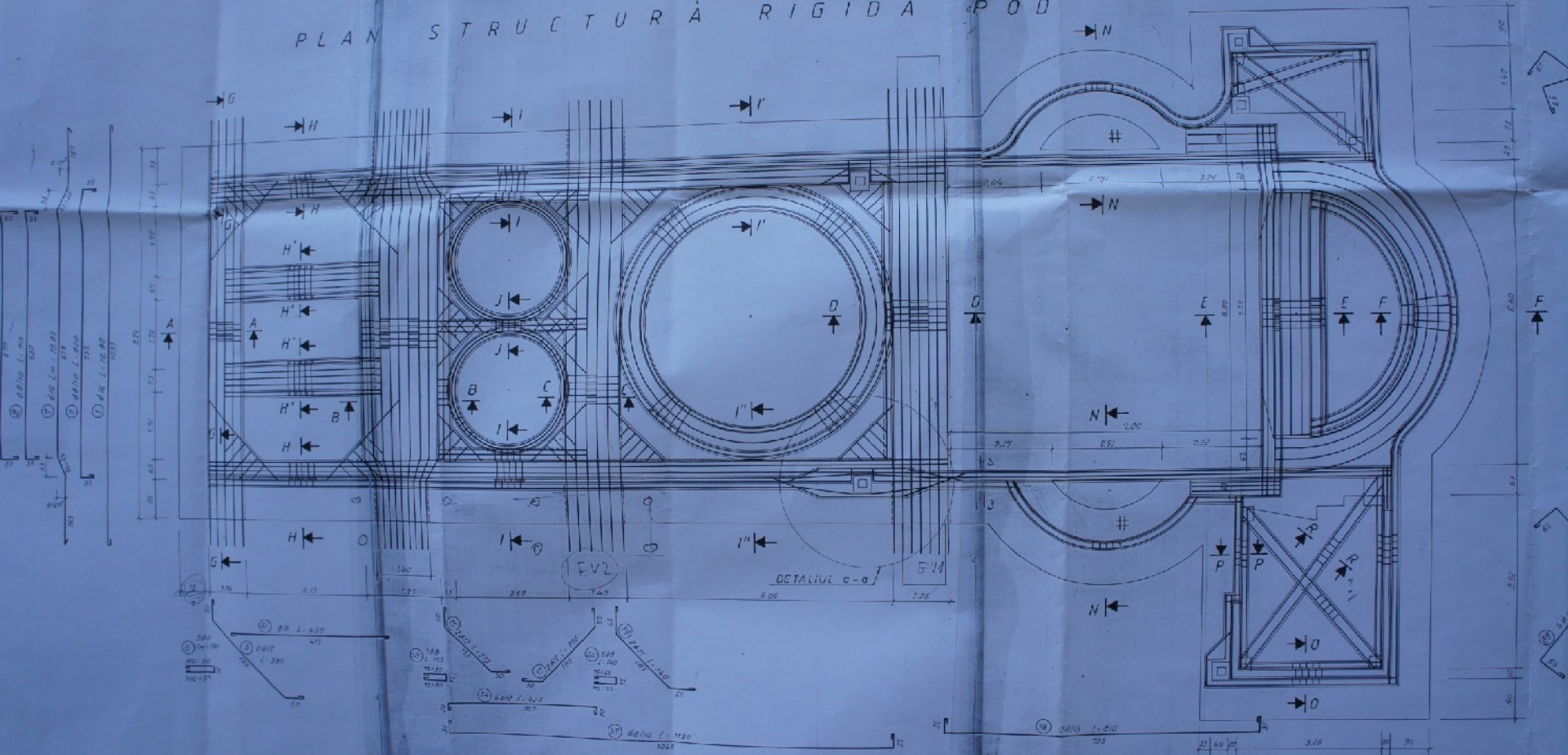

























14 6





























TURN-JUD-EST

TURN-HOCU-EST

PLANA DE PREZENTARE  
NR. 3.

+41.30m

STADUL FIZIC  
TURNUL-EST  
EXTENSIE

+30.30m

+32.00

+24.99m

EV

EV

EV

EV

EV

nota

ZONE CONSIGURATE

VERTICALE SI ORIZONTALE



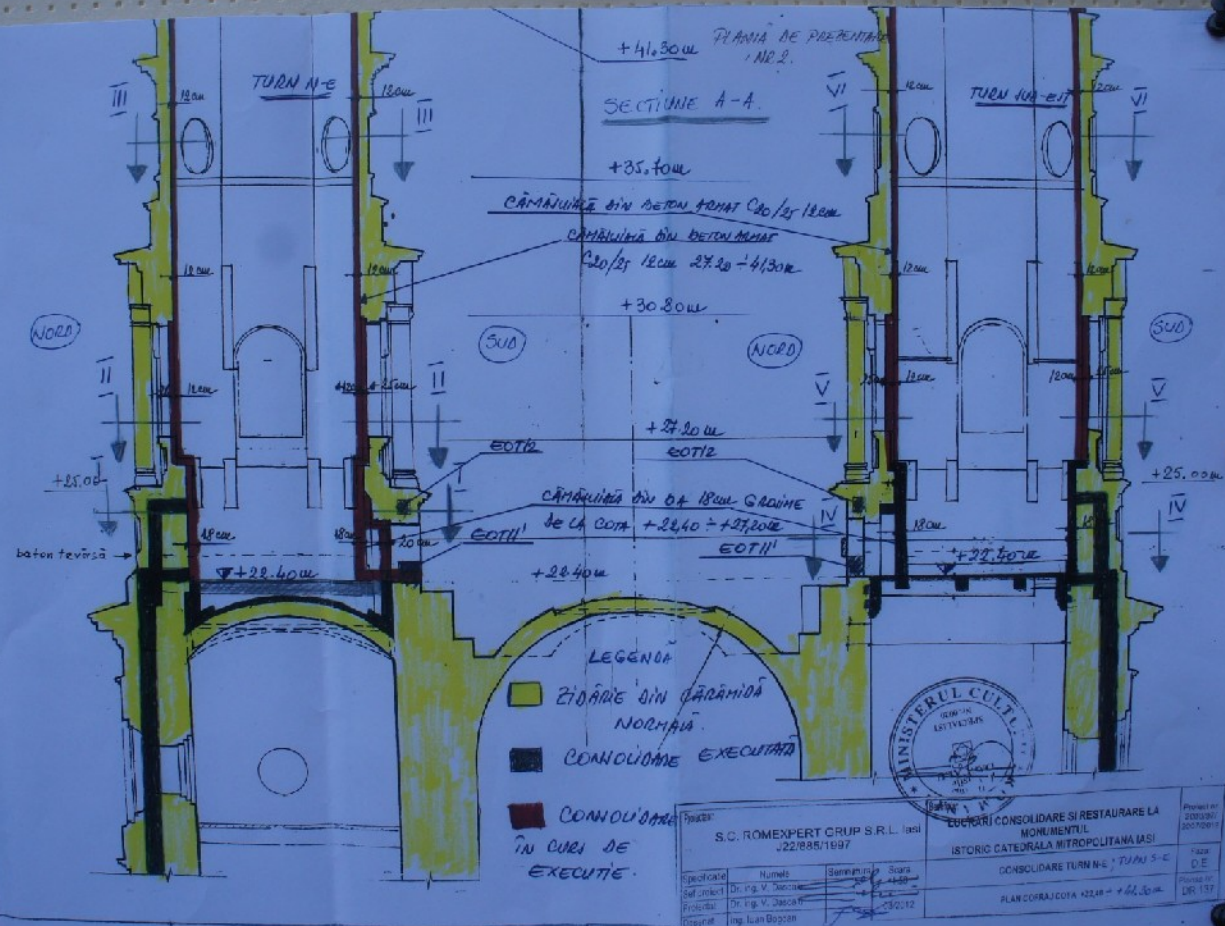



PLANȘĂ DE PREZENTARE  
NR.1.

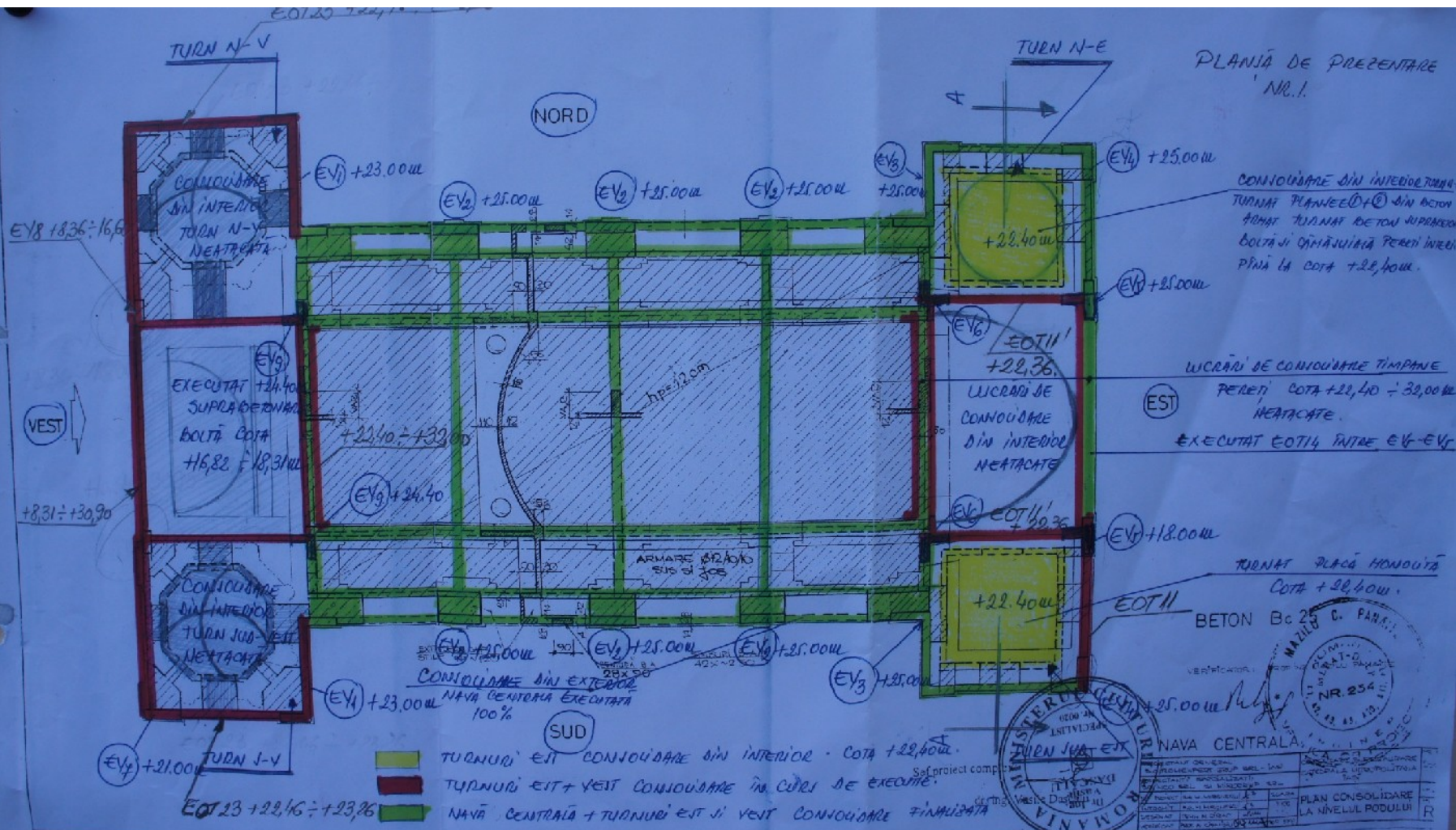

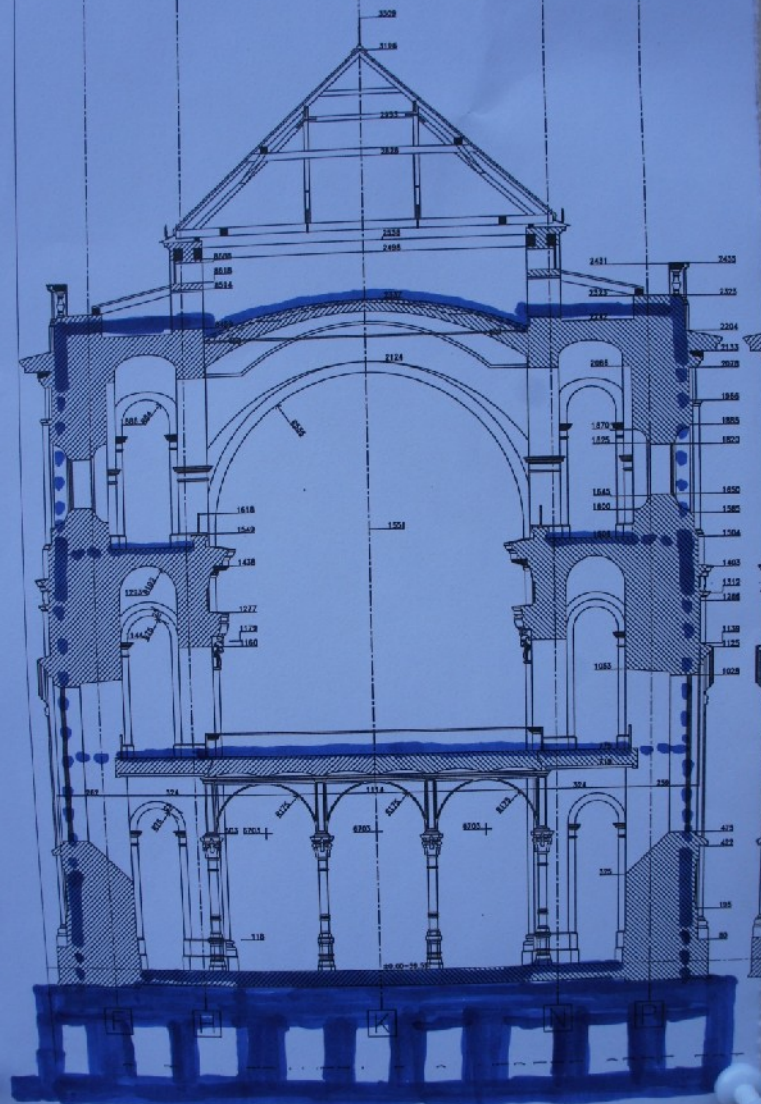



















































































14 6 196







14 6 '96



06/10/2010 16:35







13/10/2010 19:55





